

# ODOT LTV-FS ADDITIONAL OPTIONS ITEMS FOR PURCHASE

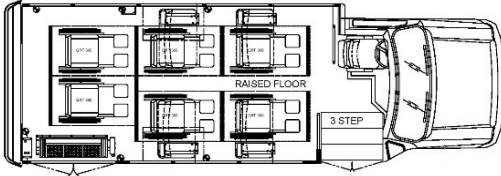

**Side Lift - up to 8 Passenger and 6 Wheelchair**

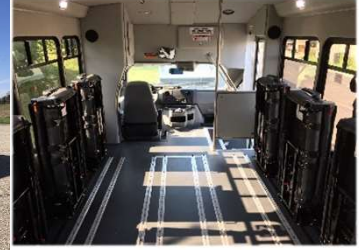
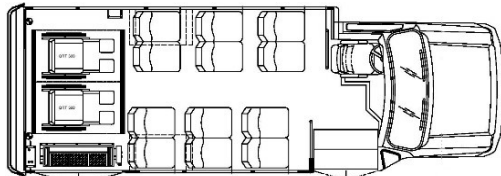

**Side Lift - 12 Passenger and 2 Wheelchair**

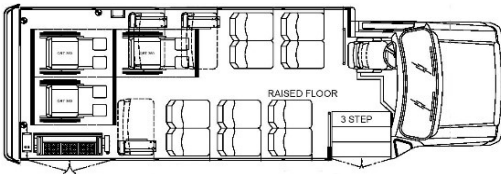

**Side Lift - 12 Passenger and 3 Wheelchair**

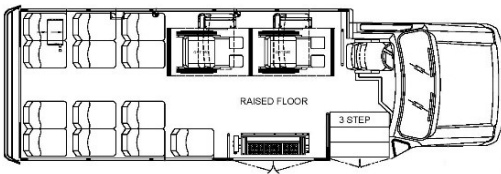

**Side Front Lift - 13 Passenger and 2 Wheelchair**

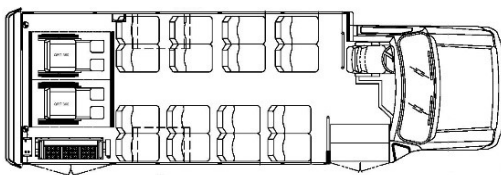

**Side Lift - 13 Passenger and 2 Wheelchair**

## Popular Options / Bus Additions

- Catalytic Converter Protection Device
- Stainless Steel Wheel Inserts
- Dual USB Ports (ea) (phone, computer, tablet charging)
- Driver Seat 6-way Power Adjustable Seat Base
- Driver Seat Upgrade - Freedman Shield Sport
- Upgraded Driver / Passenger Seat Material
- Heated Passenger Entrance Stepwell
- Work Light under hood in Engine Area
- Velvac Exterior Mirror Upgrade (40% more field-vision)
- 100% Stainless Steel Rear Bumper
- Destination Signs - Transign, Luminator, Hanover
- Upgraded Flooring Colors of your Choice
- Independent LED lights - Flashers / Turn Signals
- Interior LED Overhead Strip Lights
- Door Activated interior lights
- Strobe Light roof mount
- Twin Windows on Rear Wall (each side of rear door)
- Additional Stanchions, Handrails, Modesty Panels
- Graphics Packages from Basic to Custom



If you are interested in purchasing additional options/items to be included with your ODOT vehicle purchase, please contact your BSI representative at:

**877-696-2287 / [sales@buyabus.net](mailto:sales@buyabus.net)**

<https://www.buyabus.net/248-24-odot-bus-contract>